

Upright Cabinets

# T-11-HC

Super Slimline Upright Foodservice Refrigerator, 1 Full Solid Swing Door



| Dimensions                         |   |
|------------------------------------|---|
| External Width (mm)                | 487   |
| External Depth (mm)                | 539   |
| External Height (mm)               | 1855  |
| Exclusions                         | Depth does not include 26mm for rear bumper.            |
| Net Volume (Litres)                | 186   |
| Gross Volume (Litres)              | 311   |
| Supplied Shelves                   | 4   |
| Shelf Size (L x D mm)              | 375 x 394   |
| Internal Net Height (mm)           | 1300  |
| Unpackaged Weight (kg)             | 75  |
| Packaged Weight (kg)               | 86  |
| Packaged Dimensions (W x D x H mm) | 699 x 737 x 1909  |
| Supplied with                      | Heavy duty lock-in-place ø 51 mm castors (71 mm height) |

| Build                 |   |
|-----------------------|---|
| Door Description      | 1 Solid Swing Door                            |
| Door Opening          | Right (standard) or Left                      |
| Exterior Construction | Stainless steel front, aluminium sides & rear |
| Interior Construction | Clear coated aluminium, stainless steel base  |
| Air Intake Position   | Front   |
| Ventilation Position  | Rear  |
| Clearance Required    | 26 mm rear, zero sides                        |
| Cord Length (Meters)  | 2.74  |
| Internal Lighting     | LED   |
| Standard w/ Locks     | Standard                                      |

| Technical                      |  |
|--------------------------------|--|
| Temperature Range              | 0.5 : 3.3°C  |
| Refrigerant                    | R290   |
| Voltage/Frequency/Phase        | 220-240V/50-60Hz/1   |
| Amps                           | 0.8  |
| Watts                          | 184  |
| Climate Class                  | 5  |
| Operating Statement            | Heavy Duty: This appliance is intended for use in ambient temperatures up to 40°C. |
| Test Standard                  | EN 16825   |
| EEC                            | C  |
| Energy Efficiency Index        | 47.6   |
| Defrost Type                   | Auto   |
| Energy Consumption (kWh/24h)   | 1.19   |
| Energy Consumption (kWh/Annum) | 435  |



Specifications subject to change without notice.  
Chart dimensions rounded up to the next whole millimeter (inches rounded up to the 1/8")

UK & Ireland  
EMEA  
Australia

0800 783 2049  
[+41 61 563 07 05](tel:+41615630705)  
[+61 2 9619 9999](tel:+61296199999)

[TFIUK@truemfg.com](mailto:TFIUK@truemfg.com)  
[TrueCHCustomerService@truemfg.com](mailto:TrueCHCustomerService@truemfg.com)  
[TrueRefAus@truemfg.com](mailto:TrueRefAus@truemfg.com)



# T-11-HC

■ Super Slimline Upright Foodservice Refrigerator, 1 Full Solid Swing Door

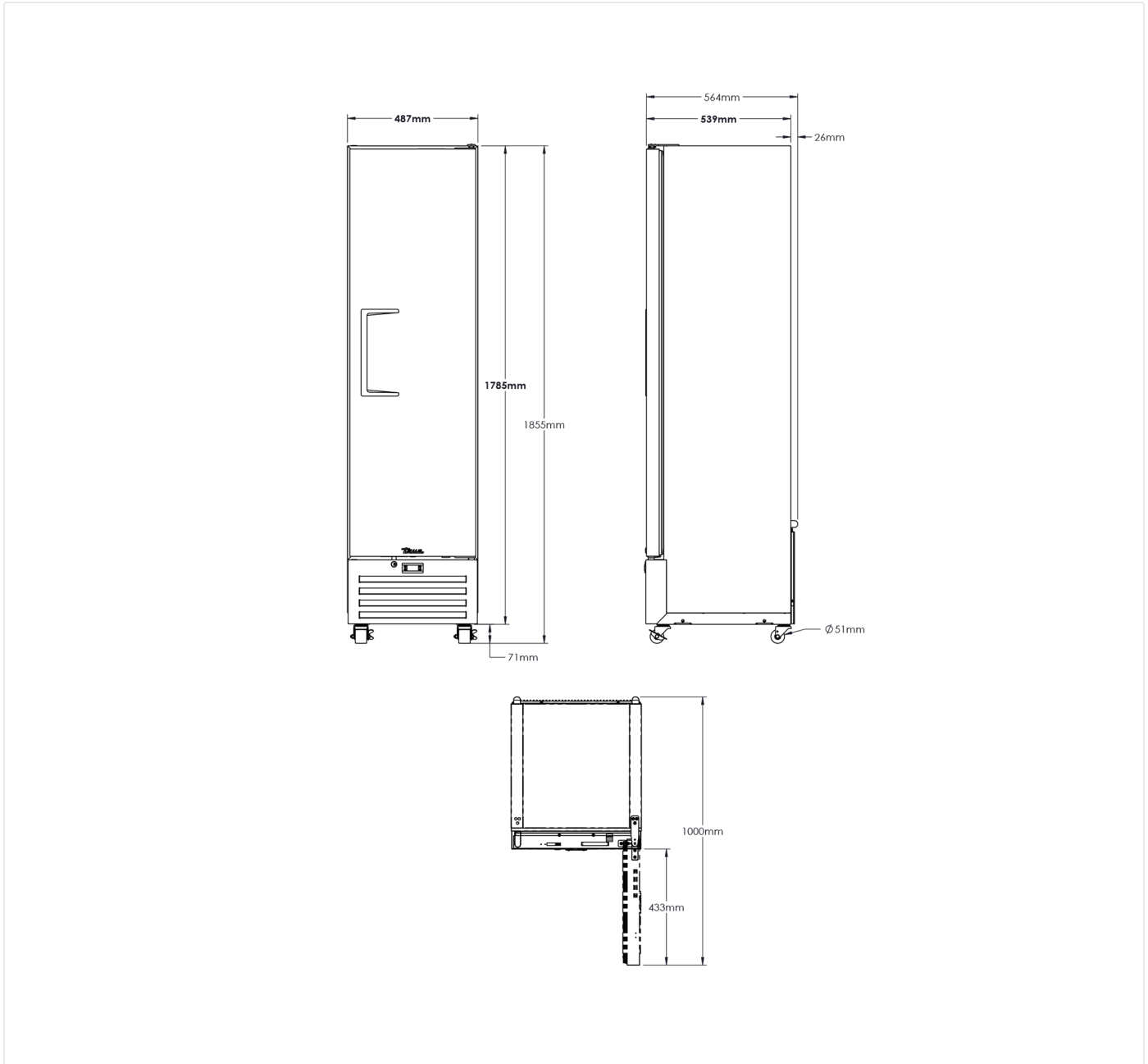

Specifications subject to change without notice.  
Chart dimensions rounded up to the next whole millimeter (inches rounded up to the 1/8")

UK & Ireland  
EMEA  
Australia

[0800 783 2049](tel:08007832049)  
[+41 61 563 07 05](tel:+41615630705)  
[+61 2 9619 9999](tel:+61296199999)

[TFIUK@truemfg.com](mailto:TFIUK@truemfg.com)  
[TrueCHCustomerService@truemfg.com](mailto:TrueCHCustomerService@truemfg.com)  
[TrueRefAus@truemfg.com](mailto:TrueRefAus@truemfg.com)

