

Glass Door Display

# GDM-72-HC~FGD01

Upright Retail Merchandiser Refrigerator, 3 Full Glass Swing Doors



Dimensions	
External Width (mm)	1985
External Depth (mm)	759
External Height (mm)	1998
Exclusions	Depth does not include 42 mm for door handle or 13 mm for rear access panel.
Net Volume (Litres)	1359
Gross Volume (Litres)	2039
Display Area (m <sup>2</sup> )	1.99
Supplied Shelves	12
Shelf Size (L x D mm)	613 x 569
Internal Net Height (mm)	1300
Unpackaged Weight (kg)	271
Packaged Weight (kg)	293
Packaged Dimensions (W x D x H mm)	2121 x 902 x 2134
Supplied with	Levelling Screws. Optional castors sold seperately.

Build	
Door Description	3 Full Glass Swing Doors
Exterior Construction	Stainless Steel/Aluminium front, Aluminium sides and rear
Interior Construction	White coated aluminium, stainless steel base
Air Intake Position	Front
Ventilation Position	Rear
Clearance Required	26 mm rear, zero sides
Cord Length (Meters)	2.74
Internal Lighting	LED
Standard w/ Locks	Not Standard. Options available.

Technical	
Temperature Range	0.5 : 3.3°C
Refrigerant	R290
Voltage/Frequency/Phase	220-240V/50Hz/1
Amps	3.7
Watts	851
Temperature Class	M1
Operating Statement	Tested at 25°C, 60% RH, per 'Refrigerators with a Direct Sales Function' for perishable food merchandising.
Test Standard	EN 23953
EEC	B
Energy Efficiency Index	19.8
Defrost Type	Auto
Energy Consumption (kWh/24h)	7.064
Energy Consumption (kWh/Annum)	2578



Specifications subject to change without notice.

Chart dimensions rounded up to the next whole millimeter (inches rounded up to the 1/8")

UK & Ireland  
EMEA  
Australia

0800 783 2049  
[+41 61 563 07 05](tel:+41615630705)  
[+61 2 9619 9999](tel:+61296199999)

[TFIUK@truemfg.com](mailto:TFIUK@truemfg.com)  
[TrueCHCustomerService@truemfg.com](mailto:TrueCHCustomerService@truemfg.com)  
[TrueRefAus@truemfg.com](mailto:TrueRefAus@truemfg.com)



# GDM-72-HC~FGD01

Upright Retail Merchandiser Refrigerator, 3 Full Glass Swing Doors

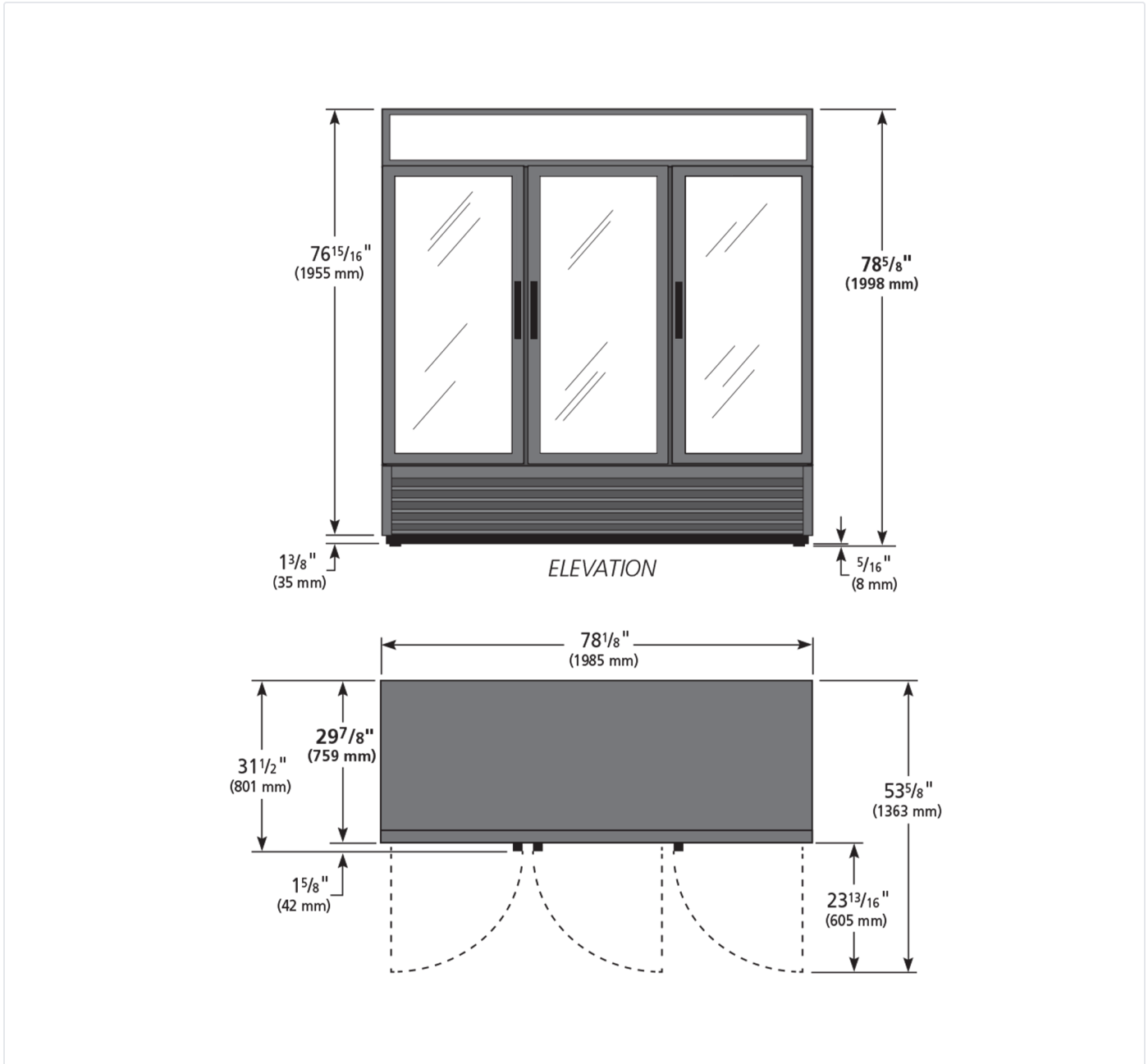

Specifications subject to change without notice.  
Chart dimensions rounded up to the next whole millimeter (inches rounded up to the 1/8")

UK & Ireland  
EMEA  
Australia

0800 783 2049  
[+41 61 563 07 05](tel:+41615630705)  
[+61 2 9619 9999](tel:+61296199999)

[TFIUK@truemfg.com](mailto:TFIUK@truemfg.com)  
[TrueCHCustomerService@truemfg.com](mailto:TrueCHCustomerService@truemfg.com)  
[TrueRefAus@truemfg.com](mailto:TrueRefAus@truemfg.com)

