

Glass Door Display

# GDM-35F-HC~TSL01

Upright Retail Merchandiser Freezer, 2 Full Glass Swing Doors



Dimensions	
External Width (mm)	1004
External Depth (mm)	759
External Height (mm)	1998
Exclusions	Depth does not include 42 mm for door handle or 13 mm for rear access panel.
Net Volume (Litres)	636
Gross Volume (Litres)	991
Display Area (m <sup>2</sup> )	1.01
Supplied Shelves	8
Shelf Size (L x D mm)	439 x 573
Internal Net Height (mm)	1300
Unpackaged Weight (kg)	189
Packaged Weight (kg)	200
Packaged Dimensions (W x D x H mm)	1083 x 902 x 2134
Supplied with	Levelling Screws. Optional castors sold separately.

Build	
Door Description	2 Full Glass Swing Doors
Exterior Construction	Black powder coated Steel front, sides and rear
Interior Construction	White coated aluminium, stainless steel base
Air Intake Position	Front
Ventilation Position	Rear
Clearance Required	26 mm rear, zero sides
Cord Length (Meters)	2.74
Internal Lighting	LED
Standard w/ Locks	Not Standard. Options available.

Technical	
Temperature Range	-23°C
Refrigerant	R290
Voltage/Frequency/Phase	220-240V/50Hz/1
Amps	3.3
Watts	759
Temperature Class	L1
Operating Statement	Tested at 25°C, 60% RH, per 'Refrigerators with a Direct Sales Function' for perishable food merchandising.
Test Standard	EN 23953
EEC	C
Energy Efficiency Index	33
Defrost Type	Auto
Energy Consumption (kWh/24h)	9.38
Energy Consumption (kWh/Annum)	3425



Specifications subject to change without notice.

Chart dimensions rounded up to the next whole millimeter (inches rounded up to the 1/8")

UK & Ireland  
EMEA  
Australia

0800 783 2049  
[+41 61 563 07 05](tel:+41615630705)  
[+61 2 9619 9999](tel:+61296199999)

[TFIUK@truemfg.com](mailto:TFIUK@truemfg.com)  
[TrueCHCustomerService@truemfg.com](mailto:TrueCHCustomerService@truemfg.com)  
[TrueRefAus@truemfg.com](mailto:TrueRefAus@truemfg.com)



Glass Door Display

# GDM-35F-HC~TSL01

Upright Retail Merchandiser Freezer, 2 Full Glass Swing Doors

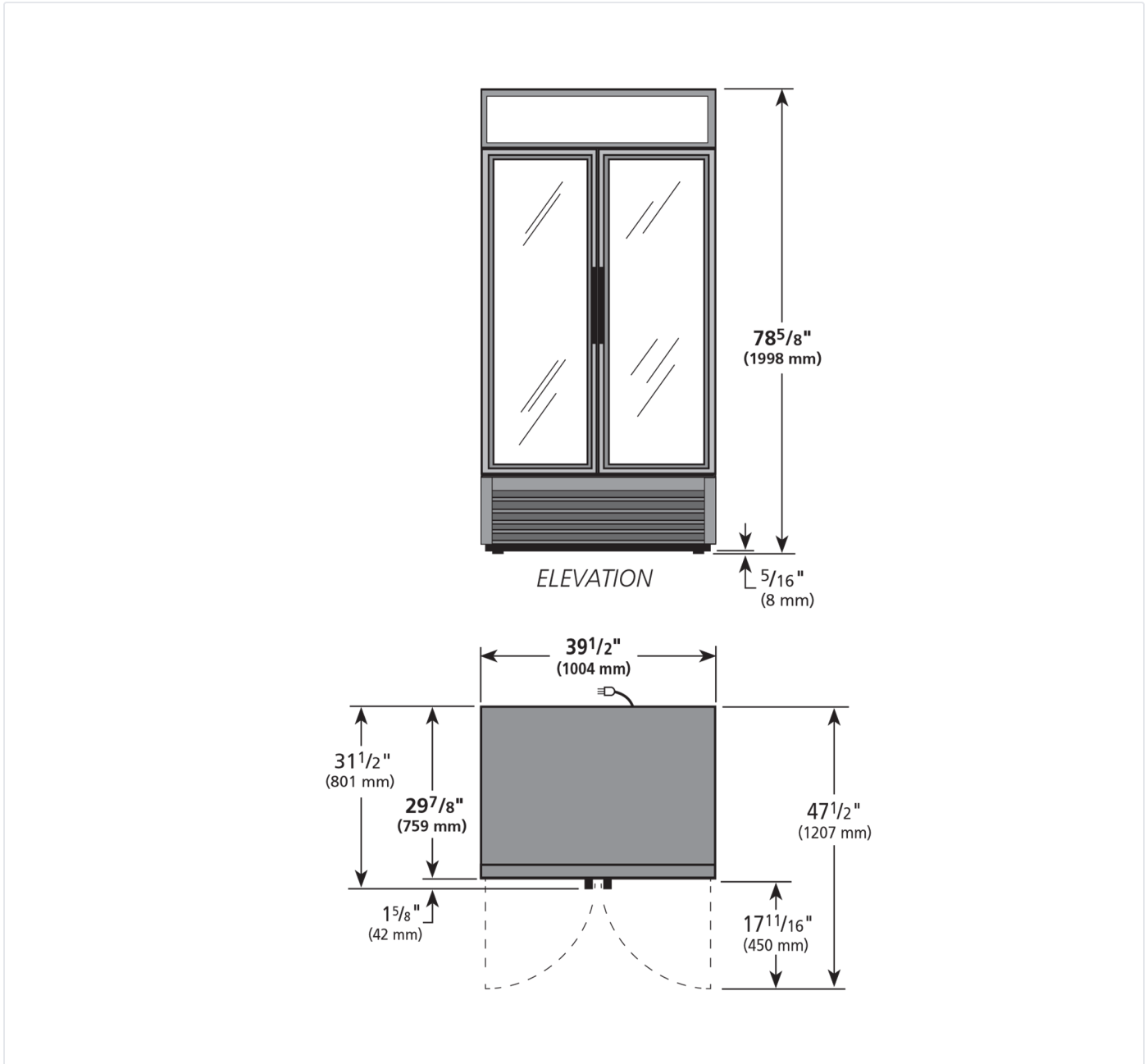

Specifications subject to change without notice.  
Chart dimensions rounded up to the next whole millimeter (inches rounded up to the 1/8")

UK & Ireland  
EMEA  
Australia

0800 783 2049  
[+41 61 563 07 05](tel:+41615630705)  
[+61 2 9619 9999](tel:+61296199999)

[TFIUK@truemfg.com](mailto:TFIUK@truemfg.com)  
[TrueCHCustomerService@truemfg.com](mailto:TrueCHCustomerService@truemfg.com)  
[TrueRefAus@truemfg.com](mailto:TrueRefAus@truemfg.com)

